

ENSCLOSURE NO. 1

SERIAL	DESCRIPTION	AREA IN SQ. MTS.	PERCENTAGE
1	ROAD AREA	184.14	10.78
2	PROPOSED WORK	1416.86	83.22
3	PROPOSED CANOPY BRIDGE	10.00	0.58
4	ROAD SET BACK	10.00	0.58
5	RECREATION GROUND	10.00	0.58
6	PLOT	10.00	0.58
7	BASEMENT LINE	10.00	0.58
8	OTHERS RESIDENTIAL BLOCK	10.00	0.58
9	PARKS	10.00	0.58
10	FLYOVER	10.00	0.58
11	RAILWAY LINE	10.00	0.58
12	SIION RAILWAY COLONY	10.00	0.58
13	SIION CHOK	10.00	0.58
14	SIION CHOK	10.00	0.58
15	SIION CHOK	10.00	0.58
16	SIION CHOK	10.00	0.58
17	SIION CHOK	10.00	0.58
18	SIION CHOK	10.00	0.58
19	SIION CHOK	10.00	0.58
20	SIION CHOK	10.00	0.58
21	SIION CHOK	10.00	0.58
22	SIION CHOK	10.00	0.58
23	SIION CHOK	10.00	0.58
24	SIION CHOK	10.00	0.58
25	SIION CHOK	10.00	0.58
26	SIION CHOK	10.00	0.58
27	SIION CHOK	10.00	0.58
28	SIION CHOK	10.00	0.58
29	SIION CHOK	10.00	0.58
30	SIION CHOK	10.00	0.58
31	SIION CHOK	10.00	0.58
32	SIION CHOK	10.00	0.58
33	SIION CHOK	10.00	0.58
34	SIION CHOK	10.00	0.58
35	SIION CHOK	10.00	0.58
36	SIION CHOK	10.00	0.58
37	SIION CHOK	10.00	0.58
38	SIION CHOK	10.00	0.58
39	SIION CHOK	10.00	0.58
40	SIION CHOK	10.00	0.58
41	SIION CHOK	10.00	0.58
42	SIION CHOK	10.00	0.58
43	SIION CHOK	10.00	0.58
44	SIION CHOK	10.00	0.58
45	SIION CHOK	10.00	0.58
46	SIION CHOK	10.00	0.58
47	SIION CHOK	10.00	0.58
48	SIION CHOK	10.00	0.58
49	SIION CHOK	10.00	0.58
50	SIION CHOK	10.00	0.58

Proforma 'B'

CONTENTS OF SHEET LAYOUT PLAN

STAMP OF DATE OF SUBMISSION OF PLAN	APPROVAL OF PLAN	STAMP OF DATE OF SUBMISSION OF PLAN

Certificate of Area
 CERTIFIED THAT I HAVE SURVEYED THE PLOT UNDER REFERENCE ON AND FOUND THAT THE AREA AS MEASURED AND STATED IN THE PROPOSAL IS CORRECT AND ACCURATE TO THE BEST OF MY KNOWLEDGE AND BELIEF AND THAT THE AREA AS MEASURED AND STATED IN THE PROPOSAL IS CORRECT AND ACCURATE TO THE BEST OF MY KNOWLEDGE AND BELIEF AND THAT THE AREA AS MEASURED AND STATED IN THE PROPOSAL IS CORRECT AND ACCURATE TO THE BEST OF MY KNOWLEDGE AND BELIEF.

SIGNATURE OF ARCHITECT
 CLIENT: MUNICIPAL CORPORATION OF GRATER MUMBAI

Description of Proposal & Property.
 PROPOSED LAYOUT OF PROPOSED RECONSTRUCTION OF EXISTING SION HOSPITAL

APPROVED BY: BRIHANMBAI MAHANGARAJA
 THIS IS TO CERTIFY THAT THE SCOPE OF WORK HAS BEEN APPROVED BY CONSIDERING THE BUDGET PROVISION. THE PROPOSAL IS SATISFIED WITH THE PROPOSAL.

DRG NO. DRAWN BY: PRATHAMESH
 DATE: 05.05.2017

Name & Address of Licensed Surveyor
 FOR M/S. ARCCO ASSOCIATES PVT. LTD. (PARCHI)
 M/S. SHASHANK MEHENDALE & ASSOCIATES

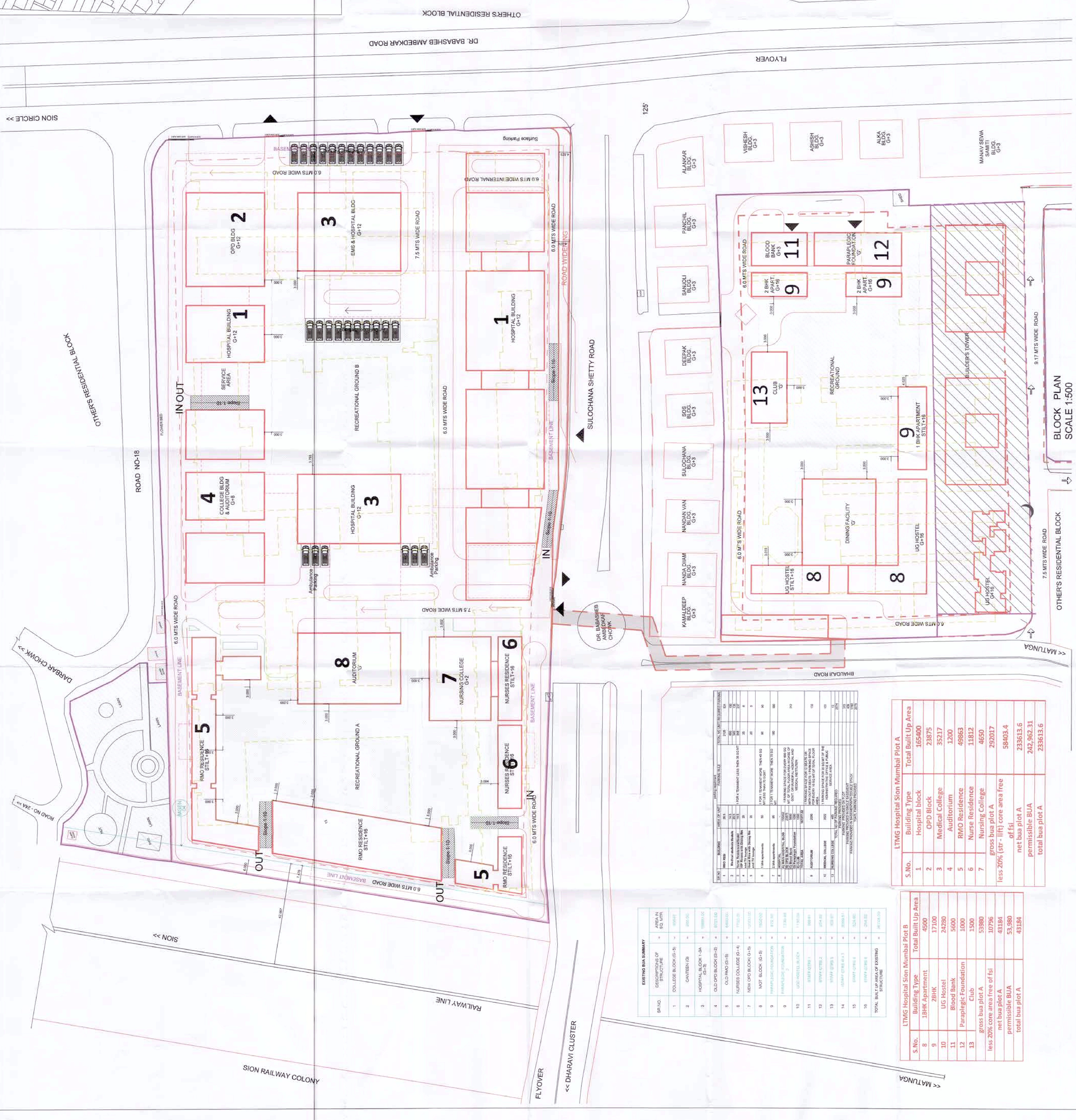

EXISTING BUA SUMMARY

SERIAL	DESCRIPTION	AREA IN SQ. MTS.	PERCENTAGE
1	ROAD AREA	184.14	10.78
2	PROPOSED WORK	1416.86	83.22
3	PROPOSED CANOPY BRIDGE	10.00	0.58
4	ROAD SET BACK	10.00	0.58
5	RECREATION GROUND	10.00	0.58
6	PLOT	10.00	0.58
7	BASEMENT LINE	10.00	0.58
8	OTHERS RESIDENTIAL BLOCK	10.00	0.58
9	PARKS	10.00	0.58
10	FLYOVER	10.00	0.58
11	RAILWAY LINE	10.00	0.58
12	SIION RAILWAY COLONY	10.00	0.58
13	SIION CHOK	10.00	0.58
14	SIION CHOK	10.00	0.58
15	SIION CHOK	10.00	0.58
16	SIION CHOK	10.00	0.58
17	SIION CHOK	10.00	0.58
18	SIION CHOK	10.00	0.58
19	SIION CHOK	10.00	0.58
20	SIION CHOK	10.00	0.58
21	SIION CHOK	10.00	0.58
22	SIION CHOK	10.00	0.58
23	SIION CHOK	10.00	0.58
24	SIION CHOK	10.00	0.58
25	SIION CHOK	10.00	0.58
26	SIION CHOK	10.00	0.58
27	SIION CHOK	10.00	0.58
28	SIION CHOK	10.00	0.58
29	SIION CHOK	10.00	0.58
30	SIION CHOK	10.00	0.58
31	SIION CHOK	10.00	0.58
32	SIION CHOK	10.00	0.58
33	SIION CHOK	10.00	0.58
34	SIION CHOK	10.00	0.58
35	SIION CHOK	10.00	0.58
36	SIION CHOK	10.00	0.58
37	SIION CHOK	10.00	0.58
38	SIION CHOK	10.00	0.58
39	SIION CHOK	10.00	0.58
40	SIION CHOK	10.00	0.58
41	SIION CHOK	10.00	0.58
42	SIION CHOK	10.00	0.58
43	SIION CHOK	10.00	0.58
44	SIION CHOK	10.00	0.58
45	SIION CHOK	10.00	0.58
46	SIION CHOK	10.00	0.58
47	SIION CHOK	10.00	0.58
48	SIION CHOK	10.00	0.58
49	SIION CHOK	10.00	0.58
50	SIION CHOK	10.00	0.58

LTMG Hospital Sion Mumbai Plot A

S.No.	Building Type	Total Built Up Area
1	Hospital Block	165400
2	OPD Block	23875
3	Medical College	35217
4	Auditorium	1200
5	RMO Residence	49863
6	Nurse Residence	11812
7	Nursing College	4650
8	gross bua plot A less 20% core area free of fsi	292017
9	net bua plot A	59403.4
10	permissible BUA	233613.6
11	total bua plot A	242,962.31
12	total bua plot A	233613.6

LTMG Hospital Sion Mumbai Plot B

S.No.	Building Type	Total Built Up Area
1	1BHK Apartment	4500
2	2BHK	17100
3	UG Hostel	24290
4	Blood Bank	5600
5	Paraplegic Foundation	1000
6	Club	1500
7	gross bua plot A	53980
8	gross bua area free of fsi	10796
9	net bua plot A	43184
10	permissible BUA	53,980
11	total bua plot A	43184